

# Mounting Accessories for Cylinders

## Mounting for CNOMO in steel

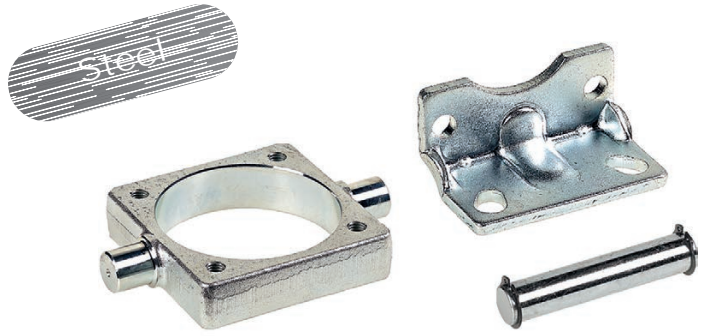

Standard executions		
Version	Sym.	Type
Counterbore flange		FL..AQCN
Threaded flange		FLF..AQCN
Low foot		PB..AQCN
Pin for rear clevis with seeger		SEC..AQCN
Round center trunnion not adjustable (threaded)		CTN..AQCN
Round center trunnion adjustable (with grains)		CT..AQCN



Technical data				
Type	Materials and treatments			
	Steel A105	Steel AVP	Fe 37	White zinking
FL..AQCN			•	
PB..AQCN			•	
SEC..AQCN		•		
CT..AQCN	•			

Note: The mounting screws are to be ordered separately.  
For screws see page 1.101.1.

**Type: FL**

Counterbore flange

Code	Item	For cyl. Ø mm	A	AP	AO	R	AS	AR	AQ	AT	AV	C	D	Weight (g)
040621	FL032AQCN	32	33	9	25	6,5	8	45	33	69	80	10,5	6	158
040622	FL040AQCN	40	40	9	32	6,5	8	52	40	78	90	10,5	6	206
040623	FL050AQCN	50	49	11	32	9	10	65	49	94	110	13,5	8	424
040624	FL063AQCN	63	59	11	45	9	10	75	59	104	120	13,5	8	504
040625	FL080AQCN	80	75	14	45	10,5	12	95	75	130	150	16,5	10	1046
040626	FL100AQCN	100	90	14	55	10,5	12	115	90	150	170	16,5	10	1480
040627	FL125AQCN	125	110	18	55	13,5	16	140	110	180	205	19	12,5	3000
040628	FL160AQCN	160	140	22	65	16,5	20	180	140	228	260	24,5	16,5	6300
040629	FL200AQCN	200	175	22	65	16,5	20	220	175	268	300	24,5	16,5	9300

**Type: FLF**

Threaded flange

Code	Item	For cyl. Ø mm	A	AP	AO	R	AS	AR	AQ	AT	AV	C	D	Weight (g)
040948	FLF032AQCN	32	33	9	25	6,5	8	45	33	69	80	10,5	6	158
040949	FLF040AQCN	40	40	9	32	6,5	8	52	40	78	90	10,5	6	206
040950	FLF050AQCN	50	49	11	32	9	10	65	49	94	110	13,5	8	424
040951	FLF063AQCN	63	59	11	45	9	10	75	59	104	120	13,5	8	504
040952	FLF080AQCN	80	75	14	45	10,5	12	95	75	130	150	16,5	10	1046
040953	FLF100AQCN	100	90	14	55	10,5	12	115	90	150	170	16,5	10	1480
040954	FLF125AQCN	125	110	18	55	13,5	16	140	110	180	205	19	12,5	3000
040955	FLF160AQCN	160	140	22	65	16,5	20	180	140	228	260	24,5	16,5	6300
040956	FLF200AQCN	200	175	22	65	16,5	20	220	175	268	300	24,5	16,5	9300

**Type: PB**

Low foot

Code	Item	For cyl. Ø mm	A	B	C	D	E	F	G	H	I	L	M	N	R	S	T	U	Weight (g)
040161	PB032AQCN	32	28	32	33	45	35	30	7	15,5	22	27	4,5	3,5	12,5	4	32	11	66
040162	PB040AQCN	40	36	36	40	52	36	30	7	16	26	27	4,5	4,5	16	4	36	15	78
040163	PB050AQCN	50	45	45	49	65	45	36	9	20,5	30	35	5,5	4,5	16	5	45	16	168
040164	PB063AQCN	63	55	50	59	75	45	35	9	20,5	30	35	5,5	4,5	22,5	5	50	18	190
040165	PB080AQCN	80	70	63	75	95	55	45	11	25,5	37	43	7	5,5	22,5	6	63	17	382
040166	PB100AQCN	100	90	75	90	115	56	44	11	27	37,5	43	7	6,5	27,5	6	73	24	452
040167	PB125AQCN	125	100	-	110	140	70	70	14	36	-	52	9	-	27,5	8	91	-	1090
040168	PB160AQCN	160	130	-	140	180	75	100	18	45	-	62	11	-	32,5	10	115	-	1180
040169	PB200AQCN	200	170	-	175	220	100	100	18	47	-	62	11	-	32,5	12	135	-	3450

It is supplied singly.

# Mounting Accessories for Cylinders

## Mounting for CNOMO in steel

### Type: SEC

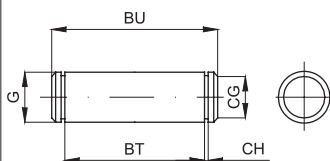

Pin for rear clevis

Code	Item	For cyl. Ø mm	G	BT	CG	CH	BU	Weight (g)
040221	SEC032AQC	32	8	46	7,6	1,1	53	21
040222	SEC040AQC	40	12	53	11,5	1,1	60	52
040223	SEC050AQC	50	12	66	11,5	1,1	73	64
040224	SEC063AQC	63	16	76	15,2	1,1	83	130
040225	SEC080AQC	80	16	96	15,2	1,1	103	160
040226	SEC100AQC	100	20	117	19	1,3	124	304
040227	SEC125AQC	125	20	142	19	1,3	149	364
040228	SEC160AQC	160	25	182	23,9	1,3	189	720
040229	SEC200AQC	200	25	222	23,9	1,3	229	872

It is supplied with 2 seegers included.

### Type: CTN

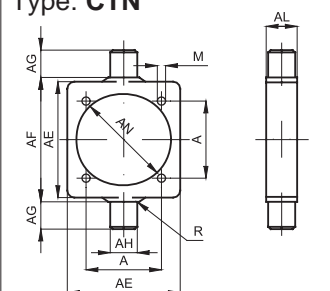

Round center trunnion not adjustable (threaded)

Code	Item	For cyl. Ø mm	A	AE	AL	AH	AG	AF	AN	R	M	Weight (g)
040541	CTN032AQC	32	33	46	15	12	12	50	37	1	M6	130
040542	CTN040AQC	40	40	59	20	16	16	63	46	1,5	M6	306
040543	CTN050AQC	50	49	69	20	16	16	73	56	1,6	M8	370
040544	CTN063AQC	63	59	84	25	20	20	90	69	1,6	M8	702
040545	CTN080AQC	80	75	102	25	20	20	108	87	1,6	M10	894
040546	CTN100AQC	100	90	125	30	25	25	131	107	2	M10	1590
040547	CTN125AQC	125	110	155	32	25	25	160	133,5	2	M12	2600
040548	CTN160AQC	160	140	190	40	32	32	200	171	2,5	M16	4300
040549	CTN200AQC	200	175	240	40	32	32	250	211	2,5	M16	7450

### Type: CT

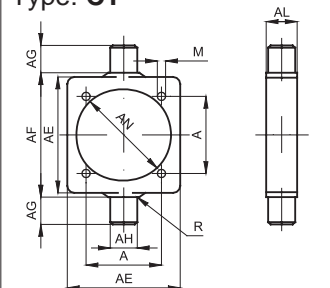

Round center trunnion adjustable (with grains)

Code	Item	For cyl. Ø mm	A	AE	AL	AH	AG	AF	AN	R	M	Weight (g)
040559	CT032AQC	32	33	46	15	12	12	50	37	1	M6	130
040558	CT040AQC	40	40	59	20	16	16	63	46	1,5	M6	306
040538	CT050AQC	50	49	69	20	16	16	73	56	1,6	M8	370
040540	CT063AQC	63	59	84	25	20	20	90	69	1,6	M8	702
040545R	CT080AQC	80	75	102	25	20	20	108	87	1,6	M10	894
040546R	CT100AQC	100	90	125	30	25	25	131	107	2	M10	1590
040580	CT125AQC	125	110	155	32	25	25	160	133,5	2	M12	2600
040630	CT160AQC	160	140	190	40	32	32	200	171	2,5	M16	4300
040597	CT200AQC	200	175	240	40	32	32	250	211	2,5	M16	7450