

LT55 SERIES

Compact linear units
with internal rail guide



- Compact design, the width of the profile 55 mm
- Internal recirculating ball rail guide size -15 -
- Double carriage design for heavier loads
- Magnetic switches in T-slot for position detection
- Toothed belt type 25 AT5
- Advanced internal lubrication system

TECHNICAL DATA

LT55-TR-S15D

Maximum stroke length	mm	5.750
Maximum speed	mm/s	3.000*
Maximum acceleration	m/s ²	30
No load torque	Nm	0,6
Repeatability	mm	± 0,1
Movement per revolution	mm	150

**depending on modell linear guide*

LT55 SERIES

TECHNICAL DATA

LOAD CAPACITY LT55-TR-S15D

Mx	Nm	106
My	Nm	106
Mz	Nm	40
Fx	N	1.200
Fy	N	3.400
Fz	N	3.600

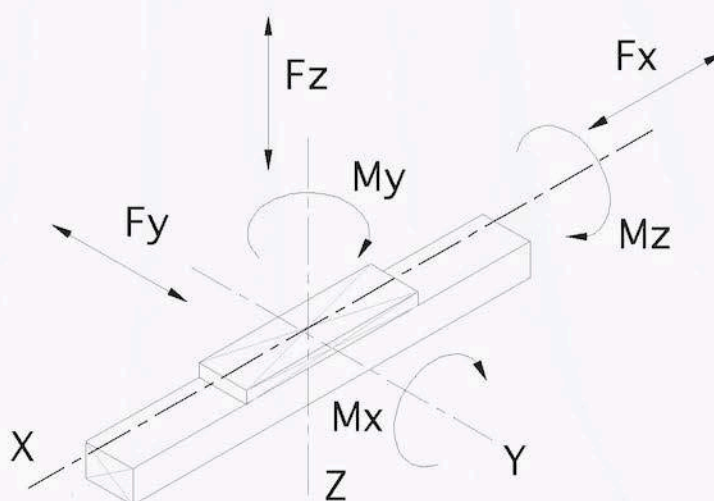

WEIGHTS (KG)

LT55-TR-S15D

Unit weight 0 mm stroke	3,69
Weight per 100 mm stroke	0,40
Mass of carriage	0,97

LT55 SERIES

DIMENSIONS

DIMENSIONS LT55-TR-S15D

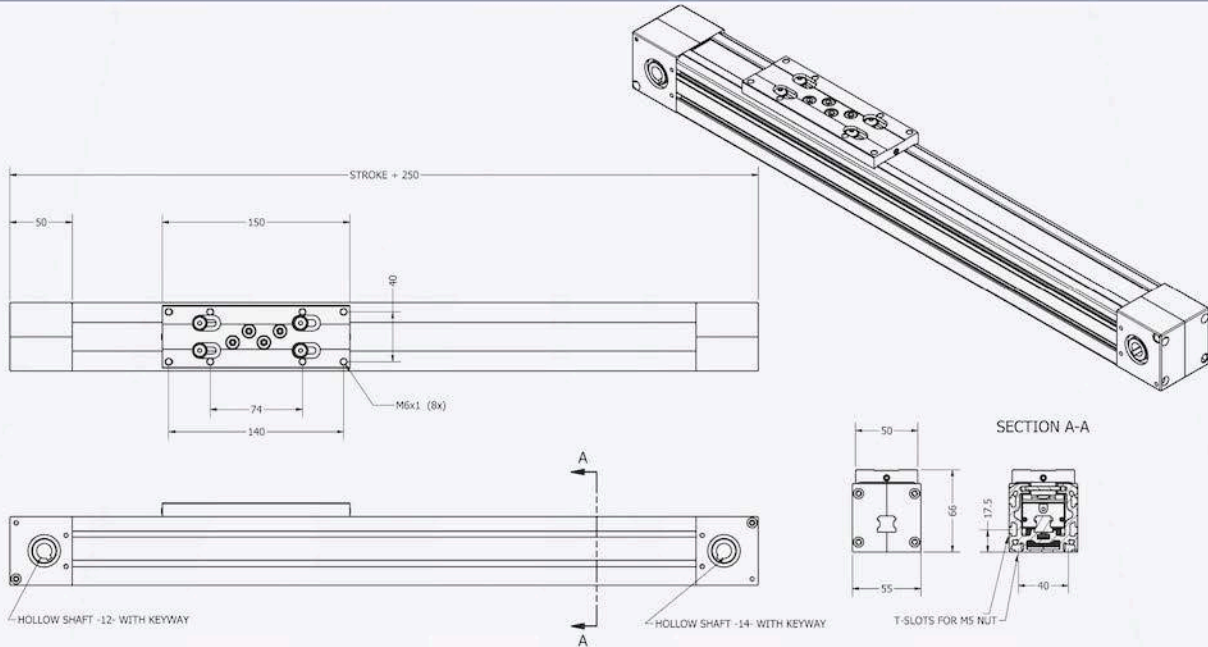

CLAMPING DIMENSIONS

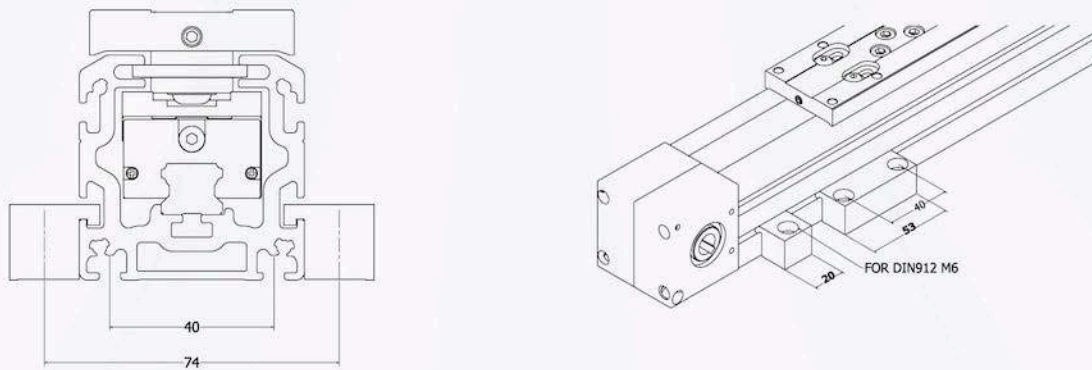

DIMENSIONS FOR MOUNTING

DIMENSIONS FOR MOTOR ATTACHEMENT

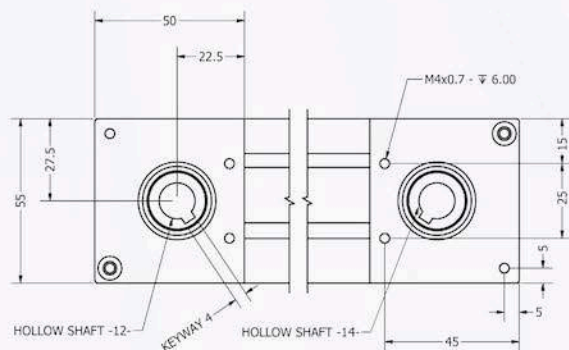
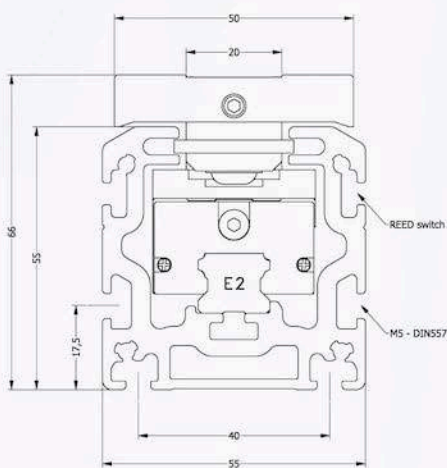

LT55 SERIES

MOTOR ACCESSORIES

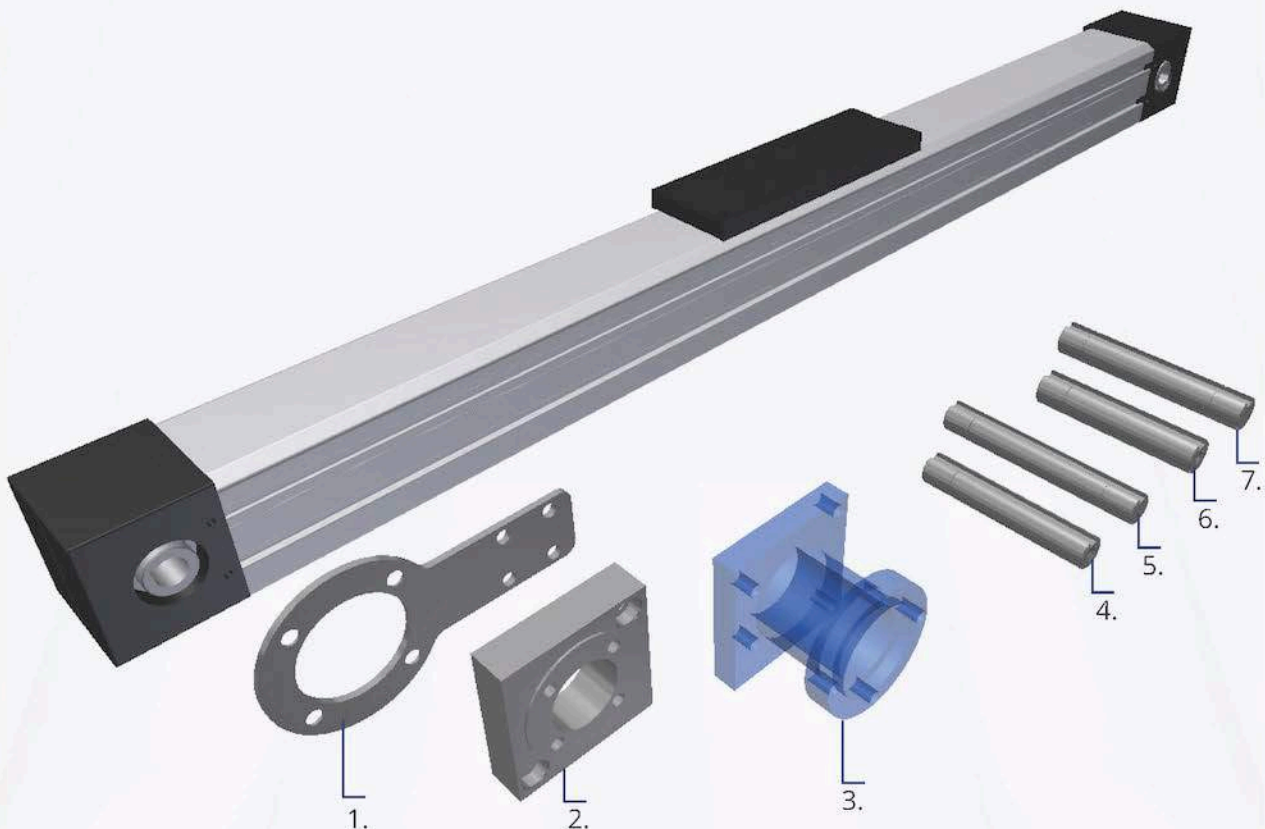

1	5570-RA-M-XXX	Motor adaptor armtype
2	5570-F-XXX	Motor Flange
3	5570-FL-XXX	Motor adaptor
4	5070-SS-12-GS14	Single shaft \varnothing 12
5	5070-DS-12-GS14	Double shaft \varnothing 12
6	5070-SS-14-GS14	Single shaft \varnothing 14
7	5070-DS-14-GS14	Double shaft \varnothing 14

LT55-TR-S15D

ACCESSORIES

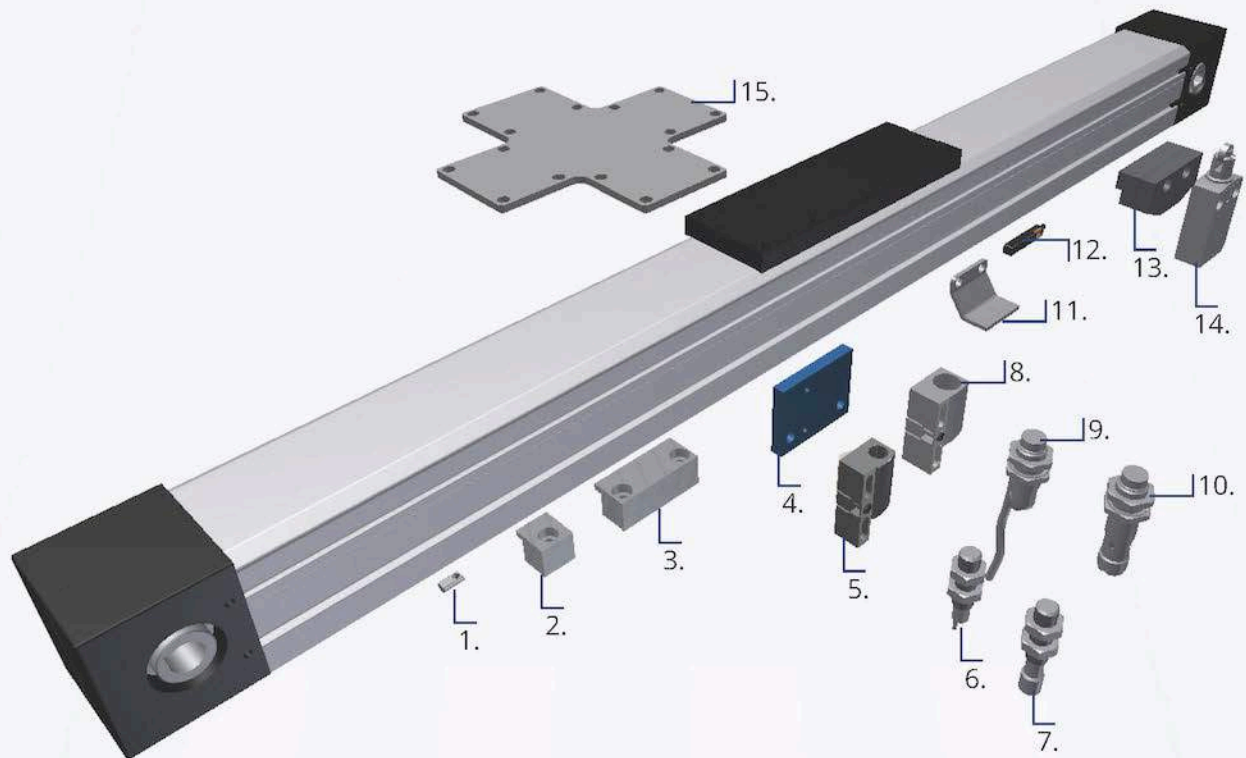

1	111-012	Nut M5
2	55121	Clamping plate single
3	55122	Clamping plate double
4	5570-SH-XS	Bracket for Telem. bracket
5	XSZB108	Bracket for M8 sensor
6	XS05B1PAL2	M8 inductive sensor-cable
7	XS508B1PAM8	M8 inductive sensor-M8
8	XSZB112	Bracket for M12 sensor
9	XS212b4pal	M12 inductive sensor-cable
10	XS212b4pbm	M12 inductive sensor-M8
11	5570-DB4-IN	Sensor Bracket
12	ASV1-C525	Reed switch
13	5570-SD-ME	Switch bracket
14	XCMD2102L	Switch with roll
15	5570-XP-D	X-Cross-bracket