

Fitting Accessories Nickel-Plated Brass / Alu



CHARACTERISTICS

BODY MATERIAL / SUITABILITY

Nickel-plated brass	CuZn39Pb3, electrolytically nickel-plated (on request also chemically nickel-plated)
Aluminium	Aluminium alloy AlCuMgPbF37

THREAD

External thread	“M” cylindrical thread: Metric ISO thread M5
External thread	“G” cylindrical thread: Whitworth pipe thread DIN ISO 228-1 G 1/8 to G 3/4
External thread	“R” conical thread: Whitworth pipe thread DIN 2999-1 and ISO 7/1 R 1/8 to R 3/4. Dimensions constructed so with inner thread there can be pairing according to DIN ISO 228-1.
Internal thread	“M” cylindrical thread: Metric ISO thread M5
Internal thread	“G” cylindrical thread: Whitworth pipe thread DIN ISO 228-1 G 1/8 to G 1/2

OPERATING PRESSURE / TEMPERATURE

Metal version	<table border="1"> <tr> <td>PN</td> <td>$T_{min} -40\text{ }^{\circ}\text{C}$</td> <td rowspan="2">Means that the fitting can be used up to the given nominal pressure PN within the specified temperature range “T”.</td> </tr> <tr> <td>50</td> <td>$T_{max} +120\text{ }^{\circ}\text{C}$</td> </tr> </table>	PN	$T_{min} -40\text{ }^{\circ}\text{C}$	Means that the fitting can be used up to the given nominal pressure PN within the specified temperature range “T”.	50	$T_{max} +120\text{ }^{\circ}\text{C}$
PN	$T_{min} -40\text{ }^{\circ}\text{C}$	Means that the fitting can be used up to the given nominal pressure PN within the specified temperature range “T”.				
50	$T_{max} +120\text{ }^{\circ}\text{C}$					
Permitted operating pressure and temperature of pipe/tube must be observed.						

THREAD SEAL

Cylindrical threaded nipple	Seal with sealing rings made of copper, fibre, aluminium, polyamide or hard PVC	
Conical threaded nipple	“G” cylindrical thread: Whitworth pipe thread DIN ISO 228-1 G 1/8 to G 3/4	
	<table border="1"> <tr> <td>Option: “D” self-sealing</td> <td>Seal with sealant Film with non-reactive mineral solid materials, non-adhesive. Resistant to air, water, motor oils etc.</td> </tr> </table>	Option: “D” self-sealing
Option: “D” self-sealing	Seal with sealant Film with non-reactive mineral solid materials, non-adhesive. Resistant to air, water, motor oils etc.	

“POSITIONABLE” VERSION

Reducer nipple type 232 see “Reducer - Positionable”	<table border="1"> <tr> <td>Not suitable for rotating or oscill. movements.</td> <td>This nipple is 360°-positionable to facilitate adjustment during assembly.</td> </tr> </table>	Not suitable for rotating or oscill. movements.	This nipple is 360°-positionable to facilitate adjustment during assembly.
Not suitable for rotating or oscill. movements.	This nipple is 360°-positionable to facilitate adjustment during assembly.		

90° Elbow

		T -40 °C T _{min} +120 °C T _{max}	Cylindrical thread	Nickel-plated brass
--	--	--	-----------------------	--------------------------------

G1	i	L3	D1	S	Weight in [g]	Type	Order number	Price
G 1/8	8	21	13	10	21.1	201M-1/8	252003	o. r.
G 1/4	10.5	26	17	13	40.4	201M-1/4	252007	o. r.
G 3/8	11.5	28	21	17	60	201M-3/8	252010	o. r.
G 1/2	15	33.5	26.5	21	106	201M-1/2	252012	o. r.
G 3/4	16.5	36.5	32	25	145	201M-3/4	252014	o. r.
G 1	19	45	39	30	245	201M-1	252016	o. r.

Illustration

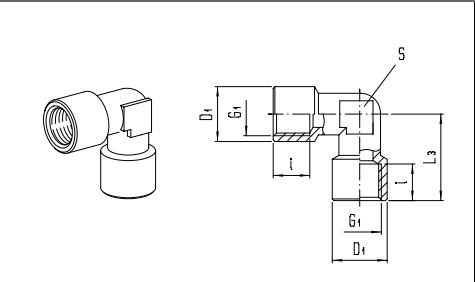

* S24 = octagon