

Double Reducing Nipple

				Cylindrical thread M,G						Nickel-plated brass		
G1	G2	i1	i2	L1	d1	d2	S	Weight in [g]	Type	Order number	Price	
M 5	G 1/8	4	6	14.5	2	5	13	8	251M-M5-1/8	250452	o. r.	
G 1/8	G 1/4	6	8	19	5	7	17	17.3	251M-1/8-1/4	250454	o. r.	
G 1/8	G 3/8	6	9	20	5	9.5	19	22.8	251M-1/8-3/8	250455	o. r.	
G 1/8	G 1/2	6	10	21.5	5	14	24*	34.3	251M-1/8-1/2	250456	o. r.	
G 1/4	G 3/8	8	9	22	7	10	19	24.1	251M-1/4-3/8	250458	o. r.	
G 1/4	G 1/2	8	10	23.5	7	14	24*	34.3	251M-1/4-1/2	250459	o. r.	
G 3/8	G 1/2	9	10	24.5	10	14	24*	36.6	251M-3/8-1/2	250461	o. r.	

Illustration

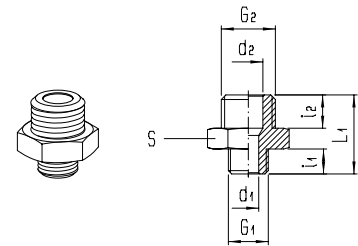

Double Reducer Nipple

				Conical thread						Nickel-plated brass		
G1	G2	i1	i2	L1	d1	d2	S	Weight in [g]	Type	Order number	Price	
R 1/8	R 1/4	7.5	11	23.5	5.5	8	14	14.8	251M-1/8K-1/4K	250554	o. r.	
R 1/8	R 3/8	7.5	11.5	24	5.5	11	17	21.1	251M-1/8K-3/8K	250555	o. r.	
R 1/8	R 1/2	7.5	14	27	5.5	15	22	33.4	251M-1/8K-1/2K	250556	o. r.	
R 1/4	R 3/8	11	11.5	27.5	8	11	17	23.8	251M-1/4K-3/8K	250558	o. r.	
R 1/4	R 1/2	11	14	30.5	8	15	22	37.8	251M-1/4K-1/2K	250559	o. r.	
R 3/8	R 1/2	11.5	14	31	11	15	22	39.5	251M-3/8K-1/2K	250561	o. r.	
R 1/2	R 3/4	14	16	37	15	19	27	69.4	251M-1/2K-3/4K	250563	o. r.	

Illustration

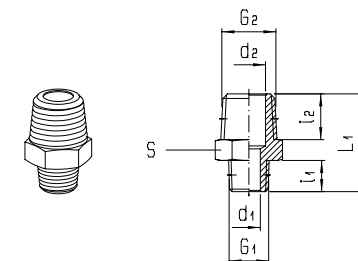

* S24 = octagon

RAPID Fittings **Stainless Steel** AISI 316L (1.4404) (Push-on)**Rapid version**

Operating pressure Technical vacuum up to maximum pressure as stated in the respective specification table under PN.

Temperature range: -40 °C to +140 °C (for restrictions see specification table)

Application

Rapid fittings are used with aggressive gaseous and liquid media, where elastomer seals are not resistant. With guide cone and cap nut these fittings are particularly suited to very harsh operating conditions.

CHARACTERISTICS

BODY MATERIAL / SUITABILITY

Stainless steel AISI 316L	Corresponds to 1.4404 stainless steel . Suitable for many aggressive media. The FKM sealing ring is FDA-compliant and can be used in the food and pharmaceutical industries.
Other materials	see relevant products
Approval	NSF/ANSI 169

TUBE

Outside diameter D [mm] Inside diameter d [mm]	6/4 8/6 10/8	12/10
Perm. tolerance outside D	±0.1	±0.15
Perm. tolerance inside d	±0.1	±0.15
Max. wall thickness tolerance	±0.1 With very soft tubes, for example PVC tubes, variations in the outside diameter or wall thickness of up to + 5/10 are allowable. In case of doubt please ask.	
Permitted grades	Polyamide (PA), polyurethane (PU), polyethylene (PE), fabric reinforced PVC, fluorine polymer (FEP and PFA)	

THREAD

External thread	"G" cylindrical thread: Whitworth pipe thread DIN ISO 228-1 G 1/8 up to G 1/2
External thread	"R" conical thread: Whitworth pipe thread DIN 2999-1 and ISO 7/1 R 1/8 up to R 1/2. Designed for pairing with internal thread according to DIN ISO 228-1.

OPERATING PRESSURE / TEMPERATURE

Metal version	PN 25 T _{min} -40 °C T _{max} +140 °C	Means that the fitting can be used up to the given nominal pressure PN within the specified temperature range "T". Allowable operating pressure and operating temperature of pipe/tube must be observed!
---------------	--	--

THREAD SEAL

Cylindrical threaded nipple	Seal with sealing rings made of copper, fiber, aluminium, polyamide or hard PVC. Seal with chambered O-ring (FDA-compliant) on request
Tapered threaded nipple	Seal with Teflon tape winding (FDA-compliant) on request
Straight, 90° elbow and T-adaptors, male	not suitable for rotating or oscill. movements Some types of fittings rotate 360° in order to facilitate alignment during assembly or for compensating movement.