

### Plug with Internal Hexagon - DIN 908

Product group		PN		T		Cylindrical thread		Nickel-plated steel		Brass	
16		50		-40 °C +120 °C							
G1	i1	L1	D1	t	S	Weight in [g]	Type	Order number	Price		
G 1/8	8	11	14	5	5	6.8	262U-1/8	251553	o. r.		
G 1/4	12	15	17.5	7	6	15.3	262U-1/4	251557	o. r.		
G 3/8	12	15	22	7.5	8	24.6	262U-3/8	251560	o. r.		
G 1/2	14	18	26	7.5	10	41.8	262S-1/2	251587	o. r.		
G 3/4	16	20	32	9	12	74	262S-3/4	251589	o. r.		

### Illustration

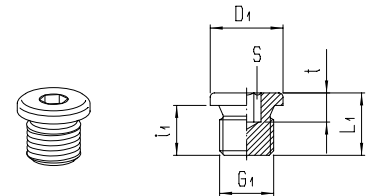

\* S24 = octagon

## Fitting Accessories Nickel-Plated Brass / Alu



## CHARACTERISTICS

## BODY MATERIAL / SUITABILITY

<b>Nickel-plated brass</b>	CuZn39Pb3, electrolytically nickel-plated (on request also chemically nickel-plated)							
<b>Aluminium</b>	Aluminium alloy AlCuMgPbF37							
<b>THREAD</b>								
External thread	"M" cylindrical thread: Metric ISO thread M5							
External thread	"G" cylindrical thread: Whitworth pipe thread DIN ISO 228-1 G 1/8 to G 3/4							
External thread	"R" conical thread: Whitworth pipe thread DIN 2999-1 and ISO 7/1 R 1/8 to R 3/4. Dimensions constructed so with inner thread there can be pairing according to DIN ISO 228-1.							
Internal thread	"M" cylindrical thread: Metric ISO thread M5							
Internal thread	"G" cylindrical thread: Whitworth pipe thread DIN ISO 228-1 G 1/8 to G 1/2							
<b>OPERATING PRESSURE / TEMPERATURE</b>								
Metal version	<table border="1"> <tr> <td>PN</td> <td><math>T_{min}</math></td> <td>-40 °C</td> </tr> <tr> <td>50</td> <td><math>T_{max}</math></td> <td>+120 °C</td> </tr> </table>	PN	$T_{min}$	-40 °C	50	$T_{max}$	+120 °C	Means that the fitting can be used up to the given nominal pressure PN within the specified temperature range "T".
PN	$T_{min}$	-40 °C						
50	$T_{max}$	+120 °C						
<b>Permitted operating pressure and temperature of pipe/tube must be observed.</b>								
<b>THREAD SEAL</b>								
Cylindrical threaded nipple	Seal with sealing rings made of copper, fibre, aluminium, polyamide or hard PVC							
Conical threaded nipple	"G" cylindrical thread: Whitworth pipe thread DIN ISO 228-1 G 1/8 to G 3/4							
	Option: "D" self-sealing	Seal with sealant Film with non-reactive mineral solid materials, non-adhesive. Resistant to air, water, motor oils etc.						
<b>"POSITIONABLE" VERSION</b>								
Reducer nipple type 232 see "Reducer - Positionable"	Not suitable for rotating or oscill. movements.	This nipple is 360°-positionable to facilitate adjustment during assembly.						